

5. Troubleshooting

Problem	Possible Cause	Solution
Encoder not incrementing	Encoder Wheel not in contact with scanning surface	Rotate Slip Joint until wheel is in contact with scanning surface and Spring Joint is slightly depressed
	Encoder Wheel not running in desired scanning direction	Loosen Pivot Knob a half turn, pivot Encoder until Encoder Wheel is running in desired scanning direction, then tighten Pivot Knob
	Encoder Connector not properly connected to scanning device	Check scanning devices instructions on properly connecting an encoder

6. Spare Parts

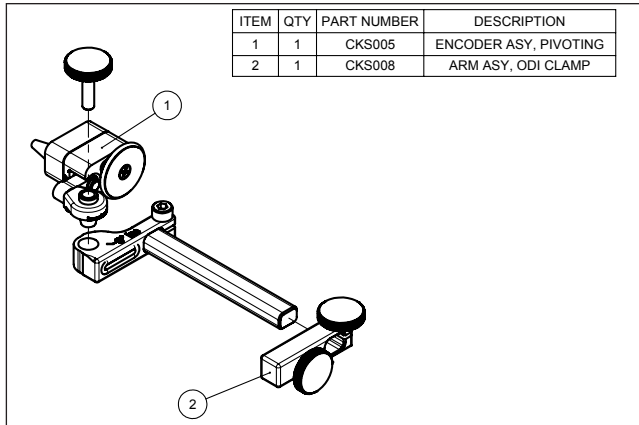

User Manual



Modular Encoder

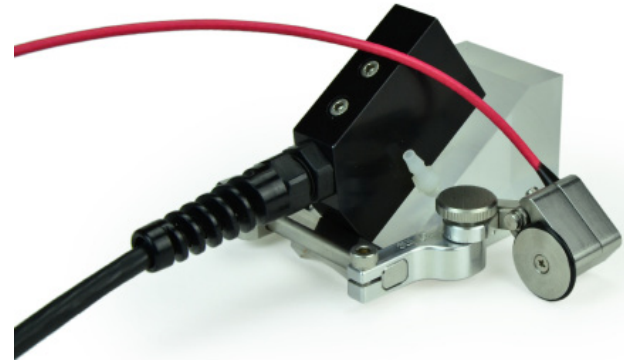

JIREH
design • create • innovate

1. Specifications

1.1. Intended Use

The ODI is a clamp-on mini encoder. It is designed to provide encoded linear position of probes in manual scanning operations.

1.2. Performance Specifications

Wedge Width	0-55 mm
Encoder Resolution	16.04 pulses/mm
Environmental Sealing	IP67

1.3. Operating Environment

The ODI is designed for use in an industrial environment that is between -40°C and 80°C.

2. Preparation For Use

2.1. Scanner Component Identification

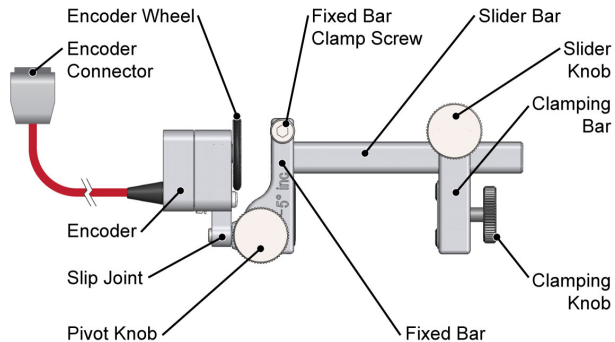

Figure 1

2.2. Scanner Setup

To setup the ODI, follow these steps:

- Loosen the clamping knob.
- Loosen the slider knob.

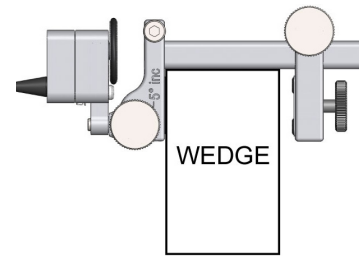

Figure 2

- Place wedge between the fixed bar and clamping bar and up against the slider bar as shown in Figure 2.
- Slide clamping bar against wedge and tighten slider knob.
- Tighten clamping knob until wedge is secured to the ODI.
- Loosen pivot knob 1/2 turn.
- Pivot encoder about the pivot knob until wheel is running in desired scanning direction.
- Tighten pivot knob.
- Rotate slip joint until encoder wheel is in contact with scanning surface and spring joint is slightly depressed.
- Connect encoder connector to scan device.

3. Operation

Hold wedge flat against scanning surface and scan straight in desired direction, ensuring that the encoder wheel is in contact with scanning surface and is rotating in direction of scan.

4. Maintenance

Wipe the scanner clean as required. Do not soak or submerge the scanner in cleaner or solvent of any kind.