

BILLY GOAT

Automated Pipeline Girth Weld Scanner



Billy Goat (carriage only, no motor)

The Billy Goat is a drive platform to be used with pipe weld bands ranging from 80mm to 140mm wide. Quick change idler drive wheel cartridges allow for easy field maintenance with minimal downtime.

See Billy Goat Ordering Information for further details

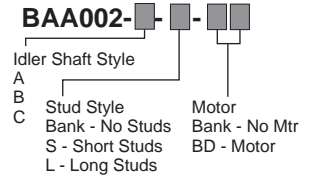

Billy Goat Motor Driver/Controller

BAA004

The Motor Controller is used to drive the Billy Goat. Some key features are; auto mode, jog mode, 4 configurable setups, selectable units and a diagnostic mode.



Billy Goat Remote Pendant

BAA005

The Remote Pendant is used to remotely operate the Billy Goat by either connecting it to the motor controller or to the end of the umbilical cable.



Billy Goat Pendant Controller Cable

BAA007- 

The Controller Cable is used to connect the Pendant to the Motor Controller.

Cable Length (m)
 006m
 015m



Billy Goat Motor to Controller Cable

BAA008- 

The Motor Cable is used to connect the Billy Goat Motor to the controller.

Cable Length (m)
 0.6m
 1.5m



Billy Goat Power Supply

BAA011

Power supply 400W 24VDC 16.7A output. 80-270VAC input.



Billy Goat Umbilical Cable

BAA012- 

The Billy Goat Umbilical provides power and signal to the motor and motor controller and also used to give an encoder output signal for the position location of the scanner.

Cable Length(m)
 005 015
 010 025
 020



Pendant to Umbilical Cable

BAA013- 

This cable allows the operator to connect the Pendant to the end of the Umbilical for remote operation.

Cable Length(m)
 005
 010



Billy Goat Water Manifold Kit

BAG001

This water manifold kit mounts to the standard Billy Goat allowing distribution of coupling fluid and or mounting of the GE[®] Weldstar[®]* inspection system

*Both "GE" and "Weldstar" are registered trademarks of the General Electric Company



Billy Goat Spare Fasteners Kit

BAG002

Common fasteners and hardware replacement kit for the Billy Goat Carraige.



Billy Goat Probe Holder Frame

The Probe Holder Frame is used to mount probe holders, an encoder and extra accesories to the Billy Goat carraige.

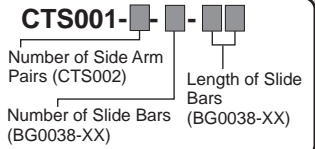

Billy Goat Frame Side Arm

CTS002

The Frame Side Members are used to create a frame to hold probe holders and accessories. When fastened together they are adjustable to compensate for different size piping.



Billy Goat Frame Arm End

CTS003

The Frame End provides a mounting point for the final Slide Bar in the Stix frame.



Spring Loaded Encoder

BGS030-B60

Encoder Assembly may be mounted on any Slide Bar with its integrated dovetail clamp. It includes a non-magnetic wheel which remains in contact with the inspected surface by means of a torsion spring. It is designed to be plugged directly in the Billy Goat Motor Controller. Patch cables are available to make a connection between the Encoder output on Billy Goat Umbilical and most instrumentation



Billy Goat Idler Shaft Cartridge - A

BAS002

Replacable Idler Shaft Cartridge Assembly, See ordering information for idler shaft details.



Billy Goat Idler Shaft Cartridge - B

BAS016

Replacable Idler Shaft Cartridge Assembly, See ordering information for idler shaft details.



Billy Goat Idler Shaft Cartridge - C

BAS019

Replacable Idler Shaft Cartridge Assembly, See ordering information for idler shaft details.



Billy Goat Idler Shaft Cartridge - D

BAS023

Replacable Idler Shaft Cartridge Assembly, See ordering information for idler shaft details.

BAA002 Ordering Information

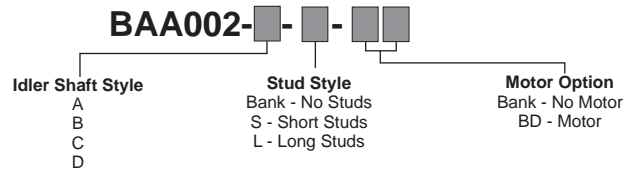

Idler Shaft A

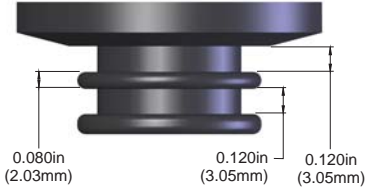

Idler Shaft B

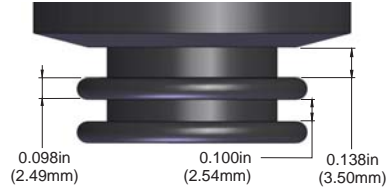

Idler Shaft C

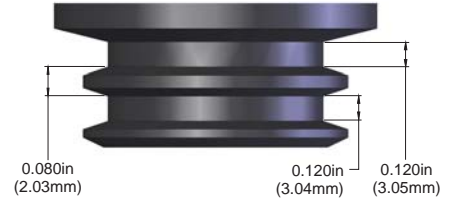

Idler Shaft D

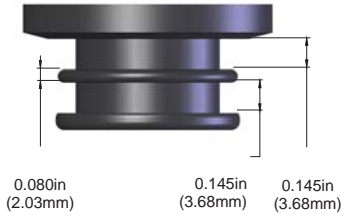

Billy Goat Stud Options

